

Prime Retail Shopping Center for Lease 22323 SHERMAN WAY



Major Center!!!

Former Chiropractic Office!!!



LOCATION:

22323 Sherman Way, West Hills, Ca 91303

SIZE:

Unit 4 – 1,080 +/- square feet

Unit 12 – 1,080 +/- square feet

RENTAL RATE:

\$1.65 per square foot, NNN (\$0.59)

OCCUPANCY:

Immediate

PARKING:

Excellent front parking

COMMENTS:

- * Adjacent to Ralph's Supermarket & Athletic Society Gym
- * High traffic count of over 30,000 +/- cars per day
- * Prominent signage on building & monument sign
- * Walking distance to many area amenities
- * Just west of Topanga Canyon Boulevard

FOR MORE INFORMATION OR A TOUR, PLEASE CONTACT:

Richard L. Paley

richard@paleycommercial.com

DRE: 00966353

Howard Bass

howard@paleycommercial.com

DRE: 00940993

19507 Ventura Boulevard, Tarzana, Ca 91356 ~ Phone (818) 343-3000 ~ Fax (818) 343-3311
www.paleycommercial.com



SITE →

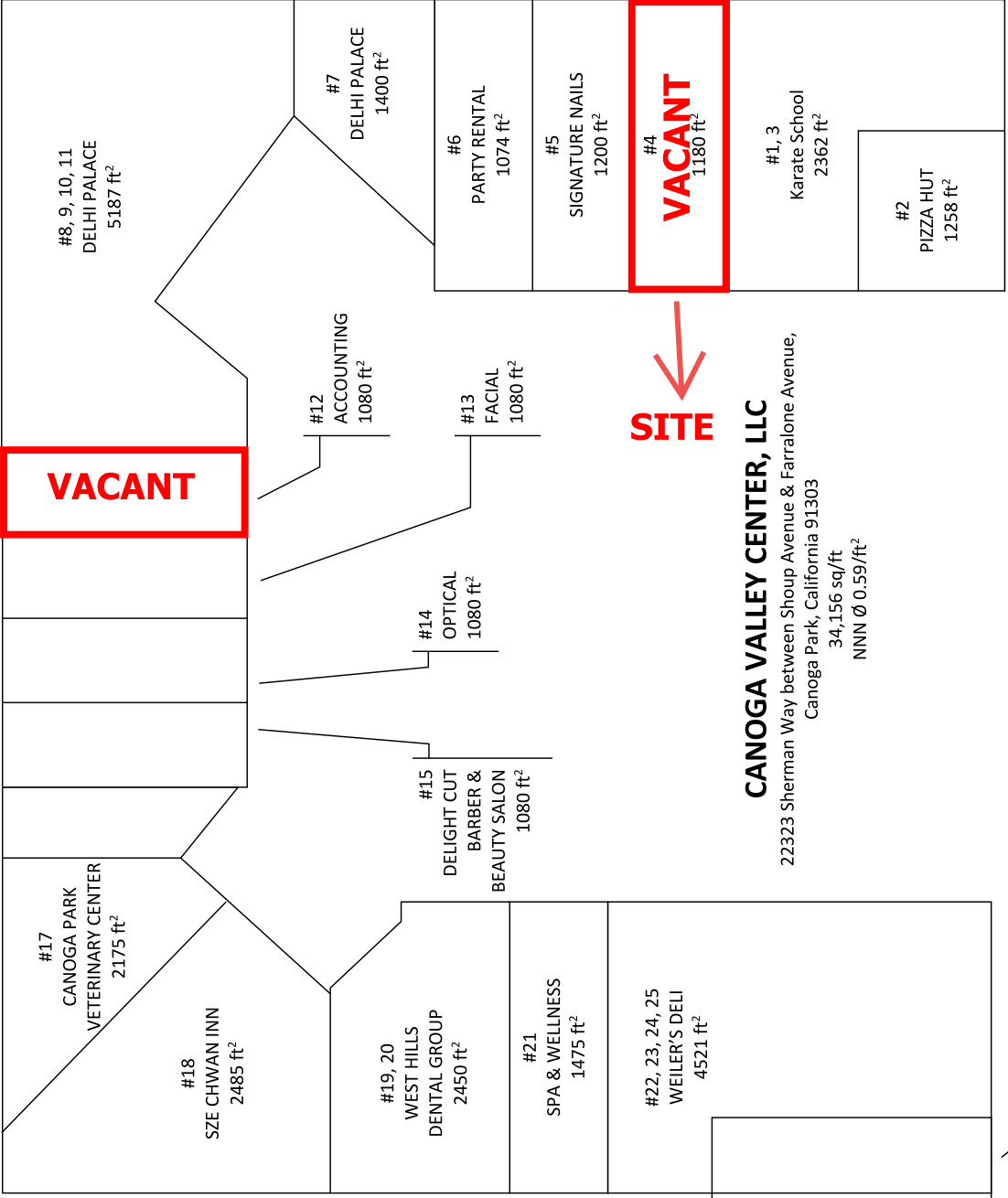

SITE

CANOGA VALLEY CENTER, LLC

22323 Sherman Way between Shoup Avenue & Farralone Avenue,
Canoga Park, California 91303
34,156 sq/ft
NNN Ø 0.59/ft²

Shoup Avenue

Sherman Way