

Prime Retail Space for Lease Oak Park Shopping Center 604 – 664 LINDERO CANYON ROAD

Food Use Available!!!

Oak Park SHOPPING CENTER

604-664 LINDERO CANYON ROAD
OAK PARK, CA 91377
(WESTLAKE VILLAGE ADJACENT)



LOCATION:

604 - 664 Lindero Canyon Road, Oak Park, Ca 91377

SIZE/ RENTAL RATE:

1,000 – 3,000/4,300 +/- sf @ \$2.50 psf, NNN (\$0.88)

15,000/ 19,300 +/- sf sf @ \$1.85 psf, NNN (\$0.88)

OCCUPANCY:

Immediate – Thirty (30) days

PARKING:

Excellent

COMMENTS:

- * Join CVS, Starbucks & Wells Fargo Bank
- * SEC Kanan Road & Lindero Canyon Road
- * Flexible lease terms
- * Patio @ food use
- * Former Martial Arts studio ready to go!

FOR MORE INFORMATION OR A TOUR, PLEASE CONTACT:

Richard L. Paley

richard@paleycommercial.com

DRE: 00966353

Howard Bass

howard@paleycommercial.com

DRE: 00940993

19507 Ventura Boulevard, Tarzana, Ca 91356 ~ Phone (818) 343-3000 ~ Fax (818) 343-3311

www.paleycommercial.com

Prime Retail Space for Lease
Oak Park Shopping Center
604 – 664 LINDERO CANYON ROAD

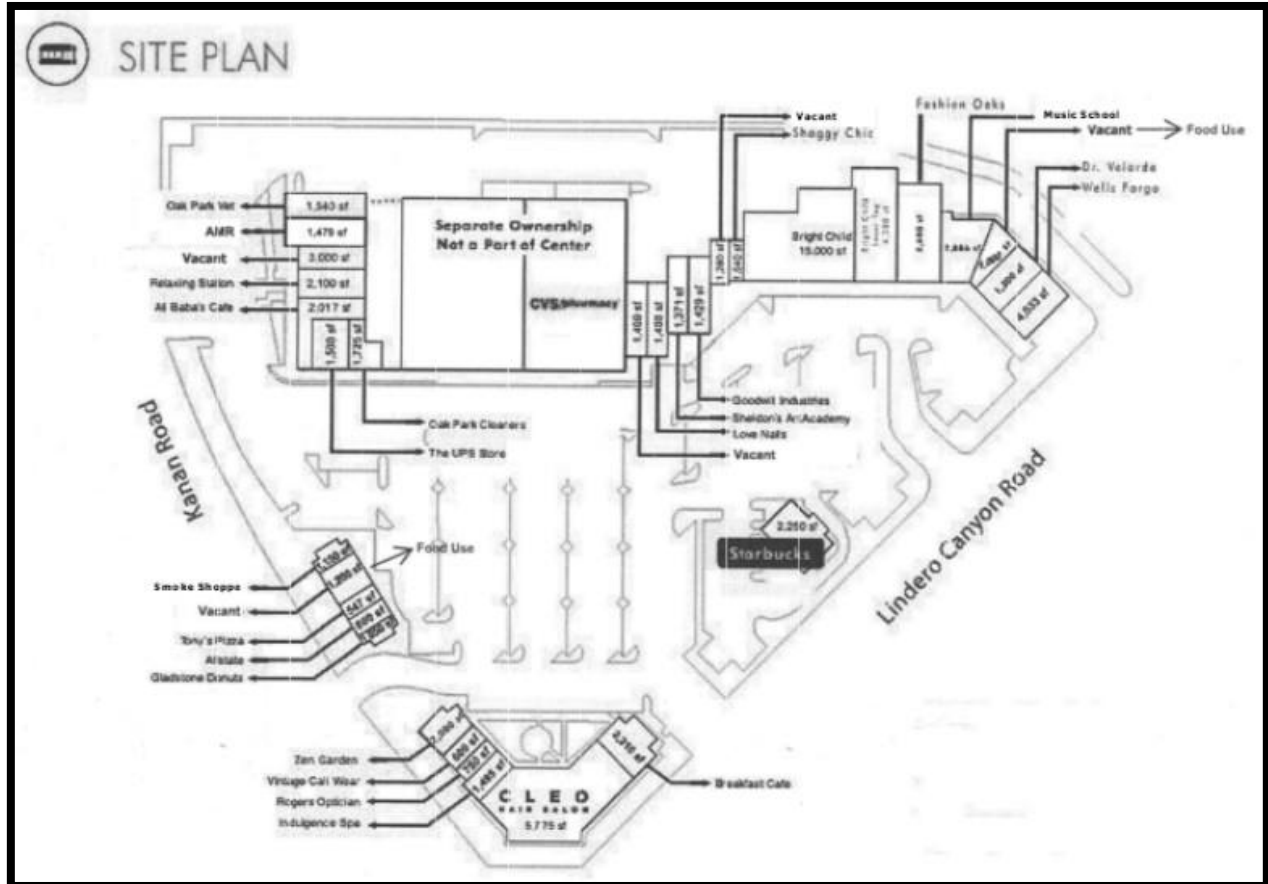

PROPERTY FEATURES:

- * High end income levels
- * Captive trade area
- * Join neighboring retailers Pavilions, CVS Pharmacy, Starbucks & Wells Fargo Bank

FOR MORE INFORMATION OR A TOUR, PLEASE CONTACT:

Richard L. Paley
richard@paleycommercial.com
DRE: 00966353

Howard Bass
howard@paleycommercial.com
DRE: 00940993

19507 Ventura Boulevard, Tarzana, Ca 91356 ~ Phone (818) 343-3000 ~ Fax (818) 343-3311
www.paleycommercial.com

**Prime Retail Space for Lease
Oak Park Shopping Center
604 – 664 LINDERO CANYON ROAD**

Demographics

	1 Mile	2 Miles	3 Miles
Residential Population	7,516	24,723	45,482
Avg Household Income	\$179,036	\$180,718	\$169,420
Daytime Population	6,355	9,737	45,090

Traffic Counts

Lindero Canyon Road	16,300 ADT (2002)
Kanan Road	9,700 ADT (2004)



FOR MORE INFORMATION OR A TOUR, PLEASE CONTACT:

Richard L. Paley

richard@paleycommercial.com

DRE: 00966353

Howard Bass

howard@paleycommercial.com

DRE: 00940993

**19507 Ventura Boulevard, Tarzana, Ca 91356 ~ Phone (818) 343-3000 ~ Fax (818) 343-3311
www.paleycommercial.com**